

2 Track Technical Details

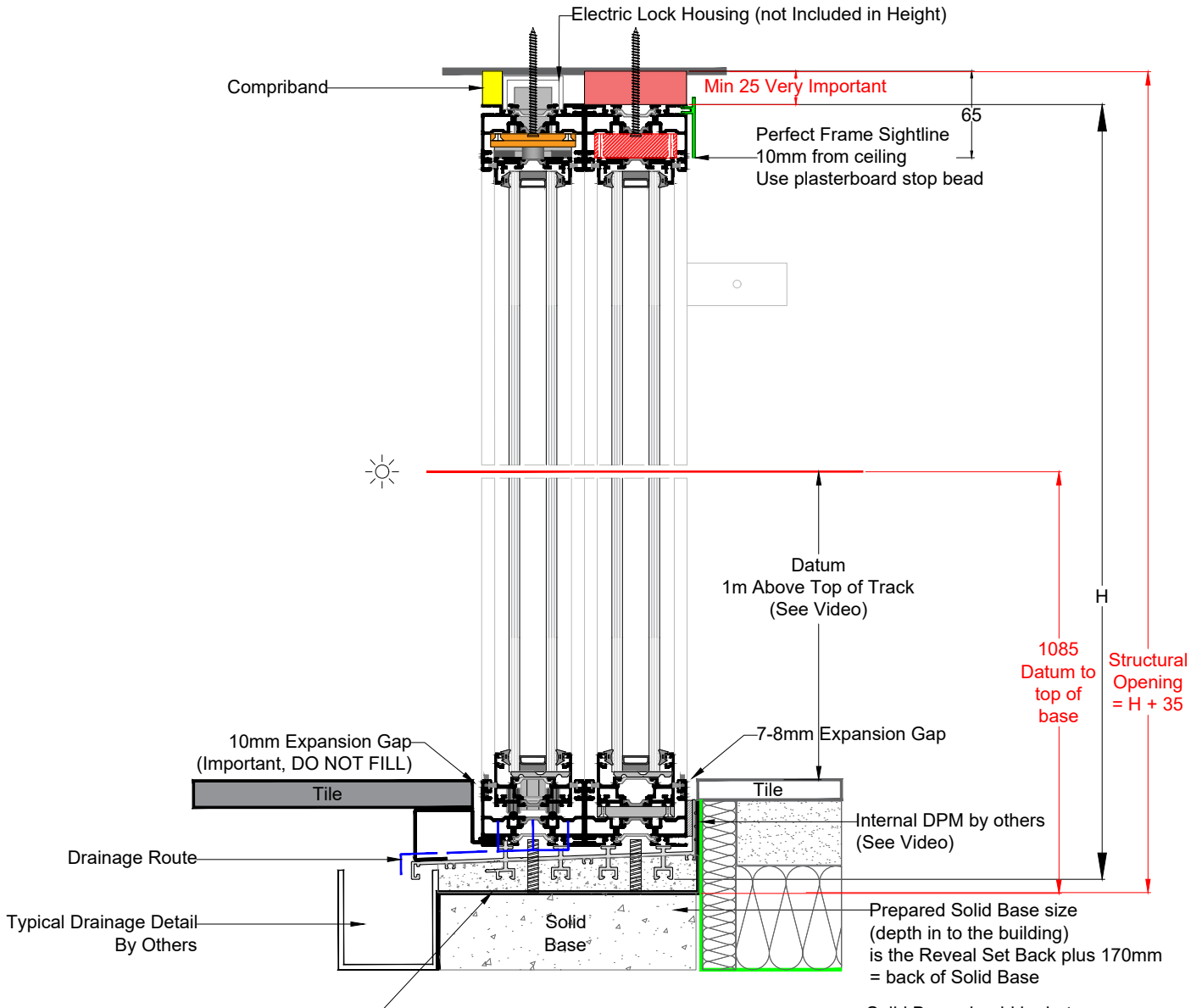

Very Important.
When Required, Waterproof tray must be a fully bonded type & be flashed in to wall reveal at correct depth for tray (dependant on Frame set back) & 150mm above the top of track

Solid Base should be between 170-200mm but NO Greater

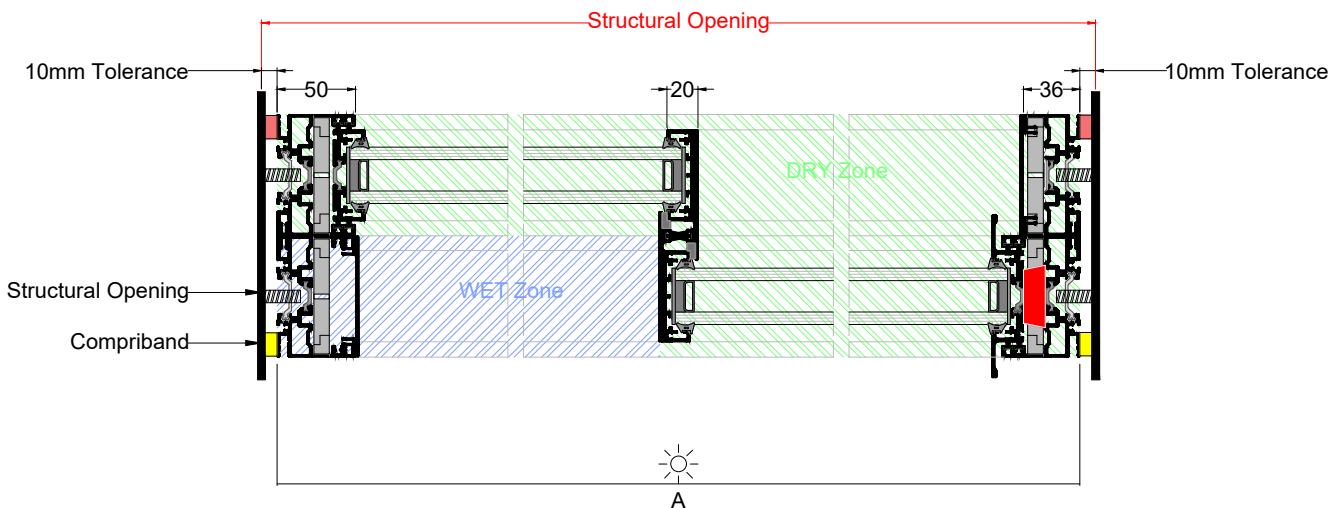

Ultraline Threshold 'Zone' Drainage

Key Principle:

The Ultraline threshold drainage detail has been designed to create two key zones within the profile. These we refer to as the "Dry Zone" and the "Wet Zone".

Wet Zone:

This area's function is to evacuate any surface water that hits the doors.

Any water that hits the external face of the door panels will run down into the threshold. This is then directed through the drainage channels and out through the drainage caps on to the drainage tray and out through drainage slots to the outside.

The main Principle of the threshold is to hold, then evacuate water.

Dry Zone:

This area's function is to allow any water that bypassed the interlock seal to be evacuated from the threshold of the door.

The drainage holes in this area have been finished with storm valves which help prevent draughts being blown back in to the property.

The inner channels of the track are designed to allow small amounts of water to drain from these areas in situations of extreme weathering - heavy storms, excessive rain / winds etc.

These internal channels have drainage holes with storm valves to allow water to escape if it does appear there.

With any door system and especially those with low threshold details, any system that opens is not hermetically sealed. We allow in our system a water route of escape.

It is possible for resting water to be present and when you start to move the door following rain, water droplets can and will drop in to the channel, these will evacuate through the relevant drainage route.

Note:

In order for this drainage system to operate effectively, the following should be observed;-

- a) All debris should be removed / cleared from the drainage channels and any further obstructions cleaned / removed.
- b) External drainage cover profiles should be present, where required, to ensure water is not trapped and can be evacuated away from the door.